

Products /  **CASTALDI** / FLEX D55 / D55 FLEX/T2 / D55/T2-MH150NB-AL

## FLEX D55 D55/T2-MH150NB-AL

### TECHNICAL DATA

#### GENERAL



|                    |   |
|--------------------|---|
| Item code          | D55/T2-MH150NB-AL   |
| Place installation | outdoor   |
| Name               | D55 FLEX/T2 / D55/T2-MH150NB-AL wall mounted, spot lights, ground mounted   |
| Standard colour    | AL - aluminium grey (similar to RAL 7040)   |
| Variant colour     | GR - graphite satin finish (similar to RAL 7022)  |
| Environments       | urban landscape, façades and architectural works, wellness, hallway, art and culture, retail areas, places of worship |



#### PHYSICAL

|                   |   |
|-------------------|---|
| Installation type | wall mounted, spot lights, ground mounted   |
| Painting          | Polyester powder coating, with a pluri-processed against corrosion (passed the exposure of over 1500 hours in a saline mist environment). |
| Screws            | AISI 304 stainless steel screws.  |
| Seals             | Silicone Rubber.  |
| Body              | Corrosion resistant die-cast aluminium body.  |

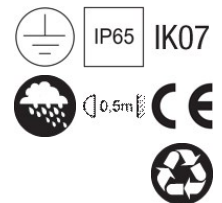

#### DIMENSIONS

D: Total diameter device (mm)      **189**

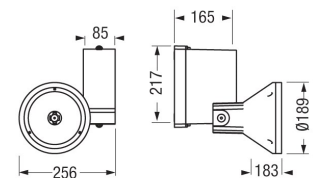

#### OPTICAL SYSTEMS

|                |                                 |
|----------------|---------------------------------|
| Opening beam   | narrow                          |
| Optical System | Safety tempered glass.          |
| Reflectors     | Extra-pure aluminium reflector. |

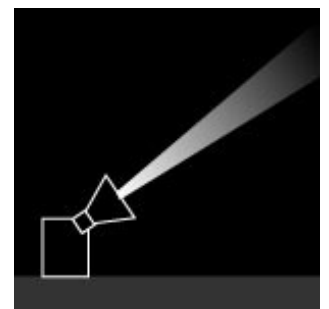

## ENERGY SAVING

This luminaire is compatible with bulbs of the energy classes:

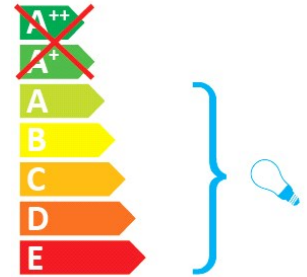

## SOURCES

| Source Type  | Source Power | System Power | Source | Lamp Socket | Sources Temperature | Colour | Nominal Flux   | Output Flux | Source description |
|--------------|--------------|--------------|--------|-------------|---------------------|--------|----------------|-------------|--------------------|
| metal halide | 150W         | -            | HIT    | G12         | -                   | -      | 12700/15500 lm | -           | -                  |

## ELECTRICAL

|                       |  |
|-----------------------|--|
| Ballast type          | Conventional   |
| Mounting ballast type | Integral   |
| Line input            | Use only (EN 60598-1) cable type H07RN-F with diameter between 7,5 and 13mm. |
| Voltage               | 220-240V   |
| Frequency             | 50-60Hz  |

## PHOTOMETRICS

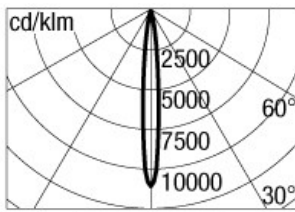

| h (m) | Ø (m) | γ=0.0 α+β=10° | MH70NB<br>Emed (lx) | MH150NB |
|-------|-------|---------------|---------------------|---------|
| 1.00  | 0.18  |               | 46759               | 99185   |
| 2.00  | 0.36  |               | 11690               | 24796   |
| 3.00  | 0.55  |               | 5195                | 11021   |
| 4.00  | 0.73  |               | 2922                | 6199    |
| 5.00  | 0.91  |               | 1870                | 3967    |

## NORMS / DIRECTIVES

|            |                          |
|------------|--------------------------|
| Norms      | EN 60598-1, EN 60598-2-5 |
| Directives | 2014/35/UE, 2014/30/UE   |

## ACCESSORIES

## OPTIONAL ACCESSORIES

### Mounting

|                       |   |
|-----------------------|---|
| Accessory code        | D55/2-BW-AL   |
| Technical description | For models D55 flex/T2. Wall mounting arm. Length 1000mm. -AL ALUMINIUM |



|                       |  |
|-----------------------|--|
| Accessory code        | D55/2-GA-AL  |
| Technical description | For models D55 flex/T2. Universal pole connection minimum Ø60mm. -AL ALUMINIUM |



|                       |   |
|-----------------------|---|
| Accessory code        | D55/2-PZ  |
| Technical description | For models D55 flex/T2. The ground spike fork shaped, allows the ground mounting of the floodlight. |



### Optical

|                       |   |
|-----------------------|---|
| Accessory code        | D55/T2-LD   |
| Technical description | For models: D30T boxer/T (28W) and D55 flex/T2. Diffused beam lens. |



Accessory code

D55/T2-LE

Technical description

For models: D30T boxer/T (28W) and D55 flex/T2. Elliptical beam lens.



Accessory code

D55/T2-R

Technical description

For models D55 flex/T2-MHNB. Radial diffuser louver 1 piece per fixture.

